

# LOW FLOW TYPE PUMP

The low flow pump has a special design casing and impeller which allows it to work very reliably at low flows. The pump has an impeller with radial vanes that twist around the hub, and a circular, concentric casing. This design ensures that, at low flows, no significant hydraulic radial forces are transmitted to the shaft. Minimum flow on this pump is "Minimum thermal flow". This is defined as the minimum flow that will not cause an excessive temperature rise.

Only the impeller and casing are special, all other parts are standard parts. Note: The adapter on the 13 in pump is the standard adapter but with 16 holes drilled in it for attachment to the casing.

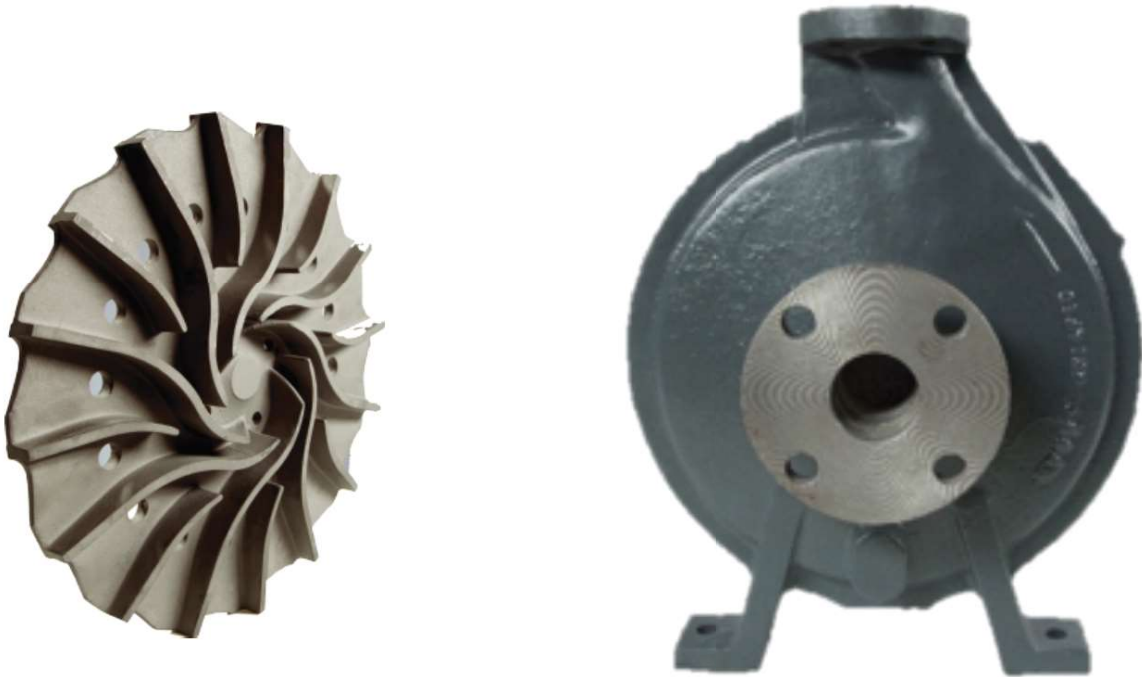

# SECTIONAL DRAWINGS

## TYPE 1L

1

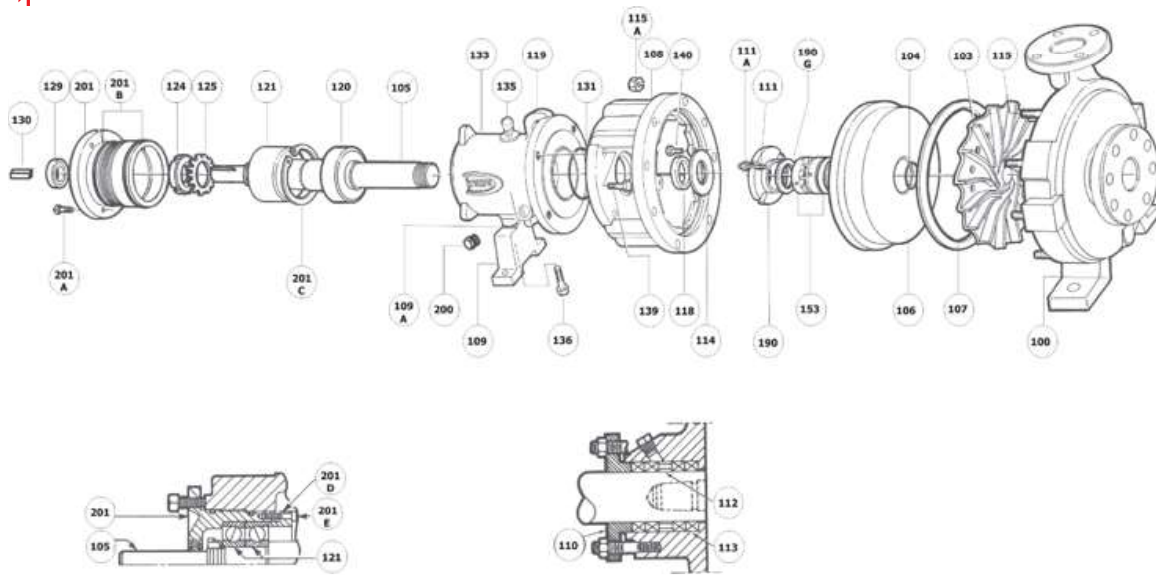

ITEM	DESCRIPTION	ITEM	DESCRIPTION	
100	Casing	124	Bearing Locknut	
103	Impeller	125	Bearing Lockwasher	
104	Impeller Gasket	129	Outboard Oil Lip Seal	
105	Shaft	131	Adapter O-Ring	
106	Cover	134	Bearing Housing Drain Plug	
107	Cover	135	Bearing Housing Vent Plug	
108	Adapter	136	Capscrew – Foot	
109	Bearing Housing Foot	139	Capscrew – Bearing Housing	N/A
110	Gland – Packing	140	Capscrew – Cover/Adapter	
111	Stud – Gland	153	Mechanical Seal	
111A	Hex Nut – Gland	177	Hook Sleeve	OPT.
112	Lantern Ring Halves	190	Gland – Mechanical Seal	
113	Packing	190G	Gland Gasket	
114	Inboard Deflector	200	Oil Sight Gage	
115	Stud – Casing	201	Carrier	
115A	Hex Nut – Casing	201A	Set Screw – Carrier	
118	Inboard Oil Lip Seal	201B	O-Ring – Carrier	
119	Bearing Housing	201C	Bearing Carrier Retainer	
120	Inboard Bearing	201D	Clap Ring Bearing Housing	OPT.
121	Outboard Bearing	201E	Socket Head Capscrew Clamp	OPT.
122	Oil Slinger			OPT.